

**EMPTY CONTAINERS AND
GOODS INSPECTIONS via
BSM direct to PEMS...**

WHAT IS PEMS?

Department of Agriculture has released a new system, called the **Plant Exports Management System (PEMS)**, for plant export Authorised Officers (AOs) and exporters of plants and plant products to simplify the plant export documentation process.

PEMS will improve the export inspection and documentation process through the efficient storage, transmission and reporting of inspection records and supporting documentation.

PEMS will eliminate the need for paper ECR and CAR documentation as data will be stored directly within the PEMS system.



HOW DOES THE PEMS MODULE WORK IN BSM?

BSM will have provision for Authorized Officers (AO'S) to bypass entering data directly into the PEMS systems and provide an option to electronically pass data from your BSM client application directly into PEMS.

The BSM PEMS Module allows for EDI messaging of inspection data between client's export software systems (BSM) and PEMS. Messaging Types include;

- Empty Container Inspection
- Containerised Goods Inspection
- Quality System Recognition Inspection

AOs can create inspections in BSM for empty containers and goods inspected against the export order and related container/s using a specifically developed **PEMS Dashboard & Mobile Device Inspection Apps**.

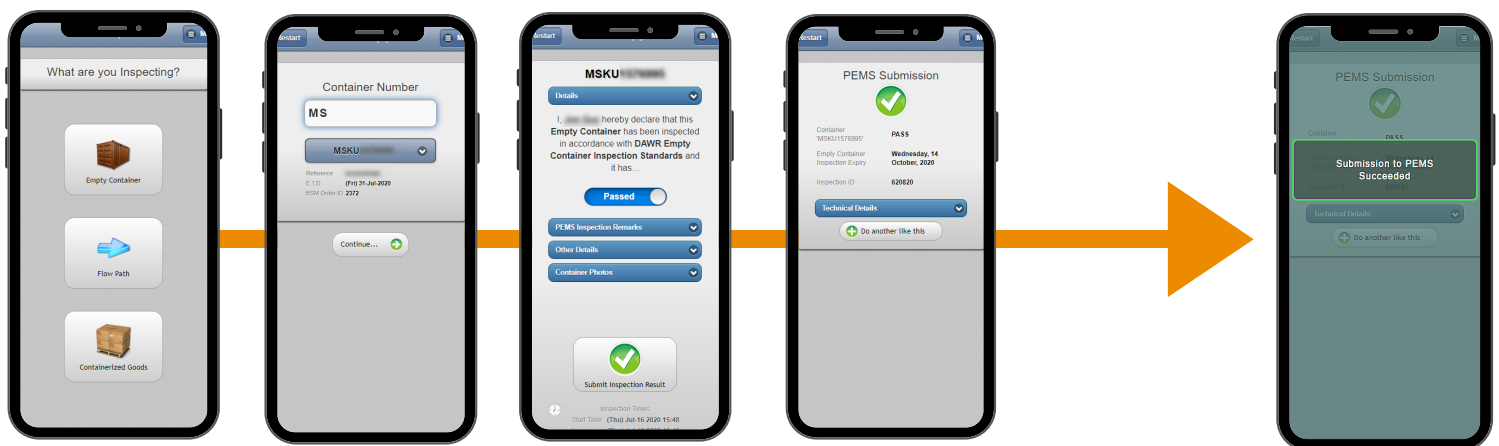

WHAT ARE THE BENEFITS?



Providing a user-friendly interface and helpful prompts to make recording data easy

Reducing data entry times



Validating AO competencies automatically

Storing inspection records and supporting documentation



Providing inspection documentation to Exporters electronically

Eliminating double handling of documents



Being available 24 hours a day, 7 days week